

- PRIMARY SURFACE AREA**  
- NO OBJECTS ALLOWED  
IN PRIMARY SURFACE
- TRANSITIONAL SURFACE AREA**  
- T1 ELEVATION 3150 MSL  
- T2 ELEVATION 3200 MSL  
- T3 ELEVATION 3250 MSL  
- T4 ELEVATION 3300 MSL
- HORIZONTAL SURFACE AREA**  
- H1 ELEVATION 3353.5 MSL
- CONICAL SURFACE AREA**  
- C1 ELEVATION 3400 MSL  
- C2 ELEVATION 3450 MSL  
- C3 ELEVATION 3500 MSL  
- C4 ELEVATION 3550 MSL  
- C5 ELEVATION 3553.5 MSL

PART 77 AIRSPACE SCHEDULE OF OBSTACLES  
RAPID CITY REGIONAL AIRPORT

OBSTACLE		CHARACTERISTICS			
ID	DESCRIPTION	ELEVATION AMSL (FT.)	PART 77 SURFACE	OBJECT PENETRATION	FUTURE DISPOSITION
14-19	ROAD	3224	APPROACH	E.F&U=2.9'(A)	TO BE RELOCATED
32-8	TRAIL	3144	APPROACH	E.F&U=1.1'(A)	TO REMAIN
5-14	POLE	3190	TRANSITIONAL	E.F&U=67.4'(B)	TO REMAIN
23-17	ROAD	3222	TRANSITIONAL	E.F&U=60.4'(B)	TO REMAIN
A-1	TOWER	3527	CONICAL	E.F&U=107'(A)	TO REMAIN
A-2	TOWER	3487	CONICAL	E.F&U=21'(A)	TO REMAIN
A-3	TOWER	3487	CONICAL	E.F&U=21'(A)	TO REMAIN
A-4	TOWER	3487	CONICAL	E.F&U=21'(A)	TO REMAIN
A-5	WINDMILL	3498	CONICAL	E.F&U=30'(A)	TO REMAIN
A-6	TOWER	3455	APPROACH	E.F&U=5'(B)	TO REMAIN
A-7	TOWER	3474	APPROACH	E.F&U=1.5'(B)	TO REMAIN
A-8	TOWER	3477	APPROACH	E.F&U=3'(B)	TO REMAIN

(A) = ABOVE SURFACE  
(B) = BELOW SURFACE

\*\* LIGHTING OF OBJECT REQUIRED  
(OL) = OBJECT LIGHTED  
(U) = UNVERIFIED LIGHTING

- NOTES:
1. SEE SHEET A-2 FOR AIRPORT & RUNWAY DATA TABLES.
  2. FOR CLOSE-IN RUNWAY AIRSPACE OBSTACLES, SEE INNER APPROACH SURFACE SHEETS.
  3. AIRSPACE APPLIED TO THIS DRAWING IS BASED ON PART 77 OF THE F.A.R.'s.
  4. OBSTACLE EL. INCLUDE TRAVERSE EL. ADJUSTMENTS.
  5. ID'S ASSIGNED TO SIGNIFICANT OBJECTS WITHIN 5' OF A SURFACE.

Rev.	Date	Description

**PRELIMINARY**  
NOT FOR  
CONSTRUCTION

DRAFTED  
APT  
REVIEWED  
KP  
PROJECT NUMBER  
10512113  
LAST REVISED DATE  
08/20/2015  
SHEET  
**A-12**



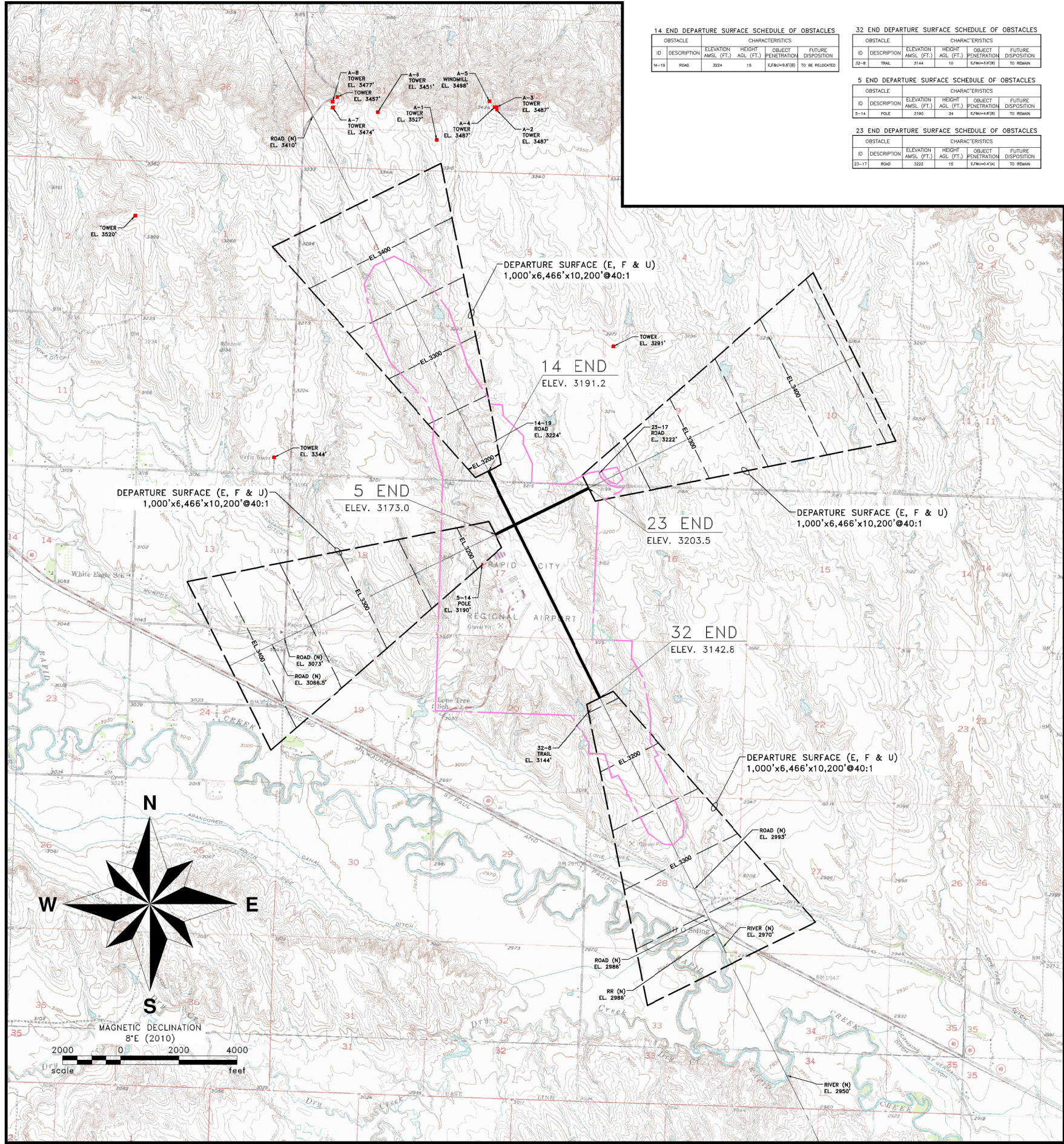

14 END DEPARTURE SURFACE SCHEDULE OF OBSTACLES				
OBSTACLE	CHARACTERISTICS			
	ID	DESCRIPTION	ELEVATION AMSL (FT.)	HEIGHT AGL (FT.)
14-15	ROAD	3224	15	EL. 3224
14-16	ROAD	3224	15	EL. 3224

32 END DEPARTURE SURFACE SCHEDULE OF OBSTACLES				
OBSTACLE	CHARACTERISTICS			
	ID	DESCRIPTION	ELEVATION AMSL (FT.)	HEIGHT AGL (FT.)
32-8	TRAIL	3144	15	EL. 3144
32-9	TRAIL	3144	15	EL. 3144

5 END DEPARTURE SURFACE SCHEDULE OF OBSTACLES				
OBSTACLE	CHARACTERISTICS			
	ID	DESCRIPTION	ELEVATION AMSL (FT.)	HEIGHT AGL (FT.)
5-14	POLE	3190	34	EL. 3190
5-15	POLE	3190	34	EL. 3190

23 END DEPARTURE SURFACE SCHEDULE OF OBSTACLES				
OBSTACLE	CHARACTERISTICS			
	ID	DESCRIPTION	ELEVATION AMSL (FT.)	HEIGHT AGL (FT.)
23-17	ROAD	3222	15	EL. 3222
23-18	ROAD	3222	15	EL. 3222

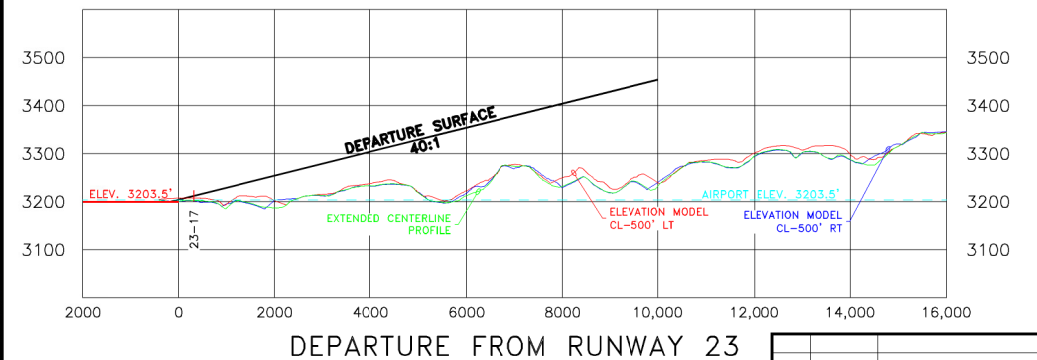
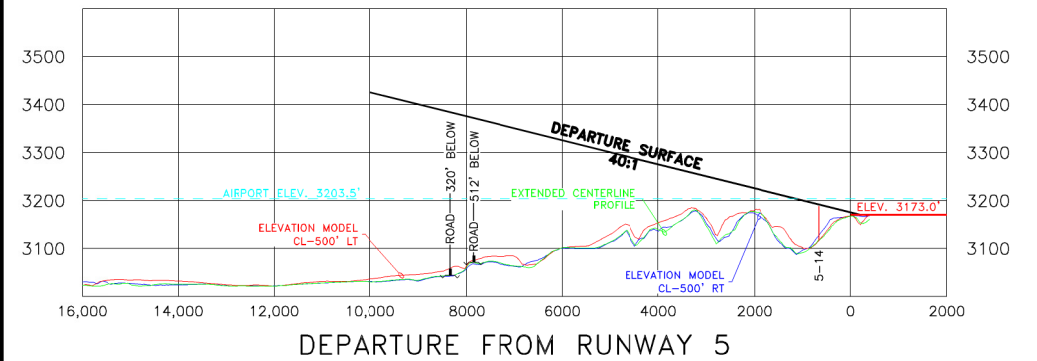
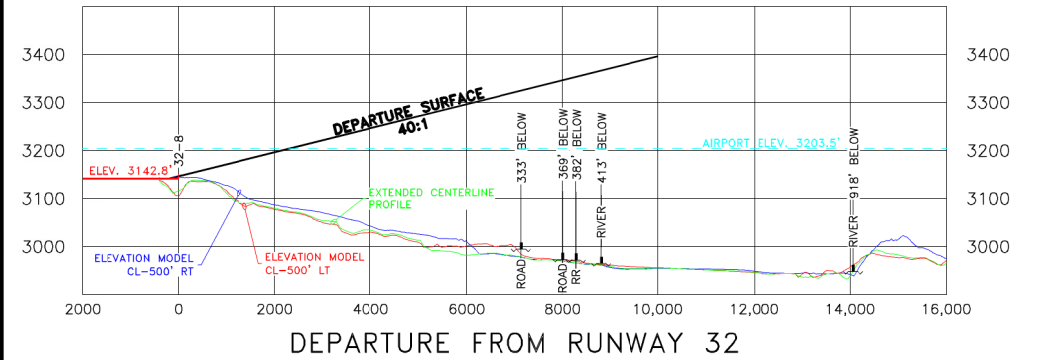
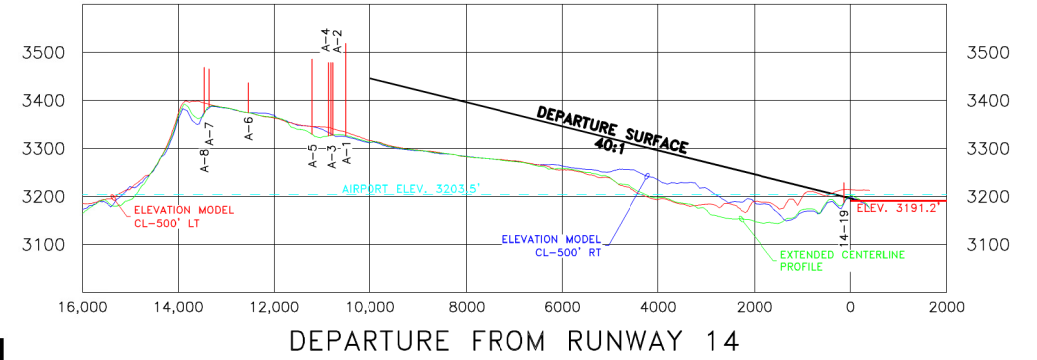

- NOTES:
1. SEE SHEET A-2 FOR AIRPORT & RUNWAY DATA TABLES.
  2. FOR CLOSE-IN RUNWAY AIRSPACE OBSTACLES, SEE INNER APPROACH SURFACE SHEETS.
  3. AIRSPACE APPLIED TO THIS DRAWING IS BASED ON PART 77 OF THE F.A.R.'s.
  4. OBSTACLE EL. INCLUDE TRAVERSE EL. ADJUSTMENTS.
  5. ID'S ASSIGNED TO SIGNIFICANT OBJECTS WITHIN 5' OF A SURFACE.

PRELIMINARY  
NOT FOR  
CONSTRUCTION



RAPID CITY REGIONAL AIRPORT  
CITY OF RAPID CITY (OWNER)  
RAPID CITY, SOUTH DAKOTA

TO BE USED AS A COMPLETE DRAWING SET FOR PLANNING PURPOSES ONLY, NOT FOR CONSTRUCTION

AIRSPACE PLAN (DEPARTURE)

DRAFTED  
APT  
REVIEWED  
KP  
PROJECT NUMBER  
10512113  
LAST REVISED DATE  
08/20/2015

SHEET  
A-13



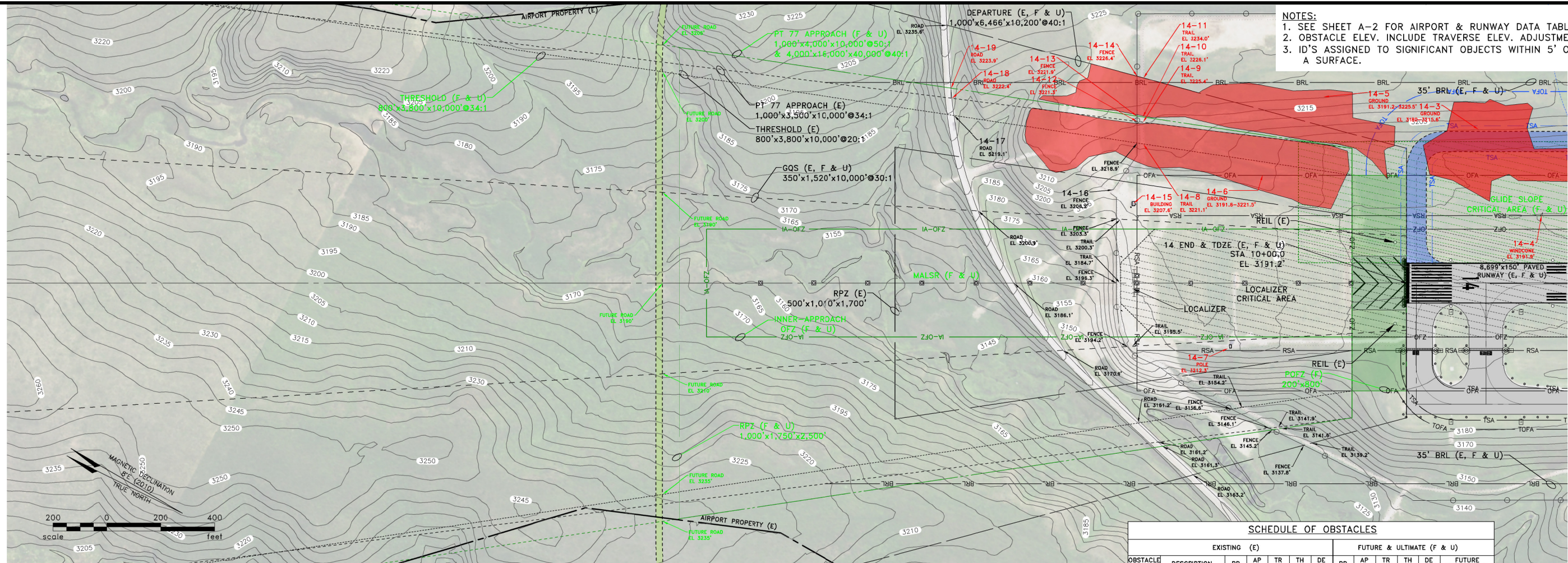

- NOTES:
1. SEE SHEET A-2 FOR AIRPORT & RUNWAY DATA TABLES.
  2. OBSTACLE ELEV. INCLUDE TRAVERSE ELEV. ADJUSTMENTS.
  3. ID'S ASSIGNED TO SIGNIFICANT OBJECTS WITHIN 5' OF A SURFACE.

SCHEDULE OF OBSTACLES												
OBSTACLE ID	DESCRIPTION	EXISTING (E)					FUTURE & ULTIMATE (F & U)					FUTURE DISPOSITION
		PR	AP 34:1	TR 7:1	TH 20:1	DE 40:1	PR	AP 50:1	TR 7:1	TH 34:1	DE 40:1	
14-3	GROUND	0-1.4'	-	0-1.3'	-	-	0-1.4'	-	0-1.3'	-	-	TO BE LOWERED
14-4	WINDCONE	3.3'	-	-	-	-	3.3'	-	-	-	-	TO REMAIN
14-5	GROUND	0-0.5'	-	(1.5)-7.5'	-	-	0-0.5'	-	0-1.1'	-	-	TO BE LOWERED
14-6	GROUND	(3.9)-1.5'	-	(12.5)-9.7'-1.5'	-	-	0-9.9'	-	(3.9)-1.1'-0.5'	-	-	TO BE LOWERED
14-7	POLE	-	7.5'	-	(2.0')	4.6'	-	11.9'	-	7.5'	4.6'	TO BE REMOVED
14-8	TRAIL	-	7.1'	-	(8.9')	5.5'	-	14.4'	-	7.1'	5.5'	TO BE LOWERED
14-9	TRAIL	-	11.3'	-	-	9.7'	-	18.8'	-	-	9.7'	TO BE LOWERED
14-10	TRAIL	-	-	9.2'	-	10.4'	-	19.3'	-	-	10.4'	TO BE LOWERED
14-11	TRAIL	-	-	(3.5')	-	18.4'	-	6.5'	-	-	18.4'	TO BE LOWERED
14-12	FENCE	-	6.8'	-	-	5.1'	-	14.1'	-	-	5.1'	TO BE LOWERED
14-13	FENCE	-	-	4.5'	-	5.7'	-	14.7'	-	-	5.7'	TO BE LOWERED
14-14	FENCE	-	-	(12.3')	-	10.2'	-	(1.93')	-	-	10.2'	TO BE LOWERED
14-15	BUILDING	-	(7.6')	-	(24.3')	(9.0')	-	0.1'	-	(7.6')	(9.0')	TO REMAIN
14-16	FENCE	-	(11.2')	-	(29.5')	(12.2')	-	(2.8')	-	(11.2')	(12.2')	TO REMAIN
14-17	ROAD	-	(15.7')	-	(14.1')	(1.7')	-	-	-	(14.1')	(1.7')	TO BE RELOCATED
14-18	ROAD	-	(12.6')	-	(11')	-	-	-	-	(11.0')	-	TO BE RELOCATED
14-19	ROAD	-	-	(16.5')	-	(9.6')	-	2.9'	-	-	(9.6')	TO BE RELOCATED

SURFACES: PR=PRIMARY AP=PT 77 APPROACH TR=TRANSITIONAL TH=THRESHOLD  
DE=DEPARTURE GQS=GLIDEPATH QUALIFICATION SURFACE #.#' = ABOVE SURFACE  
(#.#')=BELOW SURFACE \* = OBJECT LIGHTED \*\*=MAY REQUIRE OBJECT LIGHTING ~ =RPZ PENETRATION  
NOTE: AN AERONAUTICAL SURVEY IS REQUIRED FOR OBSTACLE VERIFICATION

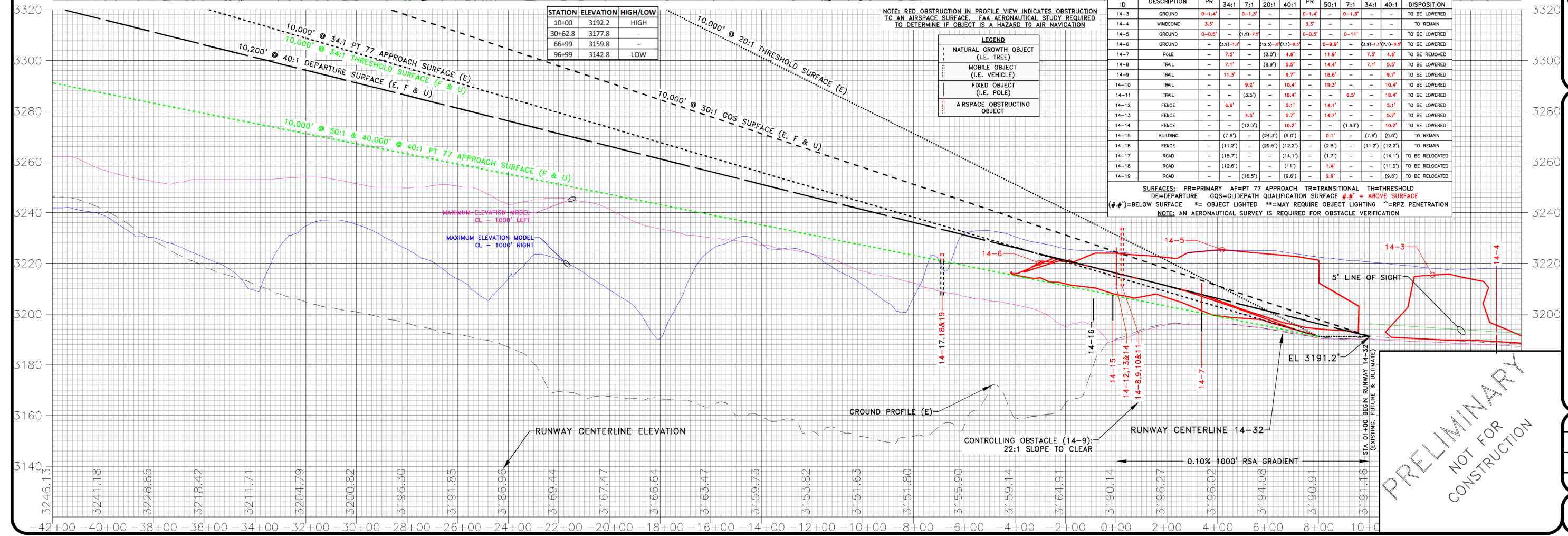

STATION	ELEVATION	HIGH/LOW
10+00	3192.2	HIGH
30+62.8	3177.8	-
66+99	3159.8	-
96+99	3142.8	LOW

NOTE: RED OBSTRUCTION IN PROFILE VIEW INDICATES OBSTRUCTION TO AN AIRSPACE SURFACE. FAA AERONAUTICAL STUDY REQUIRED TO DETERMINE IF OBJECT IS A HAZARD TO AIR NAVIGATION

LEGEND
NATURAL GROWTH OBJECT (I.E. TREE)
MOBILE OBJECT (I.E. VEHICLE)
FIXED OBJECT (I.E. POLE)
AIRSPACE OBSTRUCTING OBJECT

PRELIMINARY  
NOT FOR  
CONSTRUCTION

RAPID CITY REGIONAL AIRPORT

CITY OF RAPID CITY (OWNER)  
RAPID CITY, SOUTH DAKOTA

INNER APPROACH SURFACE  
RUNWAY 14 END

DRAFTED  
TLG  
REVIEWED  
KP  
PROJECT NUMBER  
10512113  
LAST REVISED DATE  
08/20/2015  
SHEET  
A-14



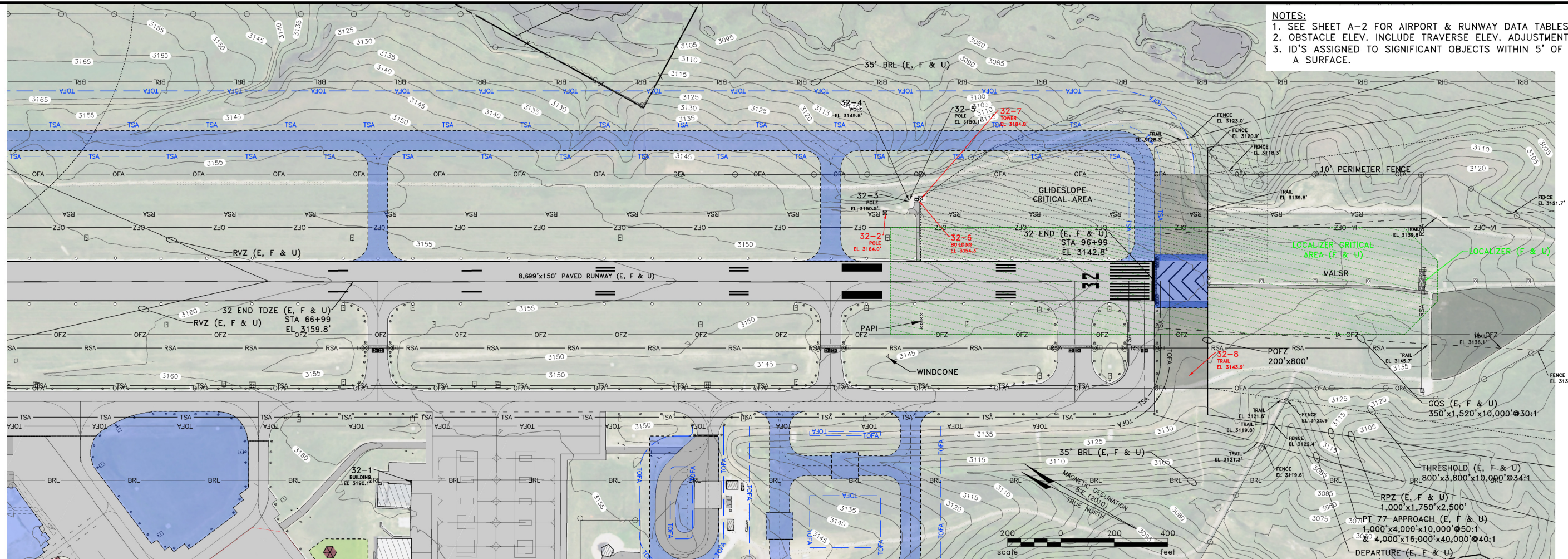

NOTES:  
1. SEE SHEET A-2 FOR AIRPORT & RUNWAY DATA TABLES.  
2. OBSTACLE ELEV. INCLUDE TRAVERSE ELEV. ADJUSTMENTS.  
3. ID'S ASSIGNED TO SIGNIFICANT OBJECTS WITHIN 5' OF A SURFACE.

**RAPID CITY REGIONAL AIRPORT**  
CITY OF RAPID CITY (OWNER)  
RAPID CITY, SOUTH DAKOTA

TO BE USED AS A COMPLETE DRAWING SET FOR PLANNING PURPOSES ONLY, NOT FOR CONSTRUCTION

**SCHEDULE OF OBSTACLES**

EXISTING, FUTURE & ULTIMATE						
OBSTACLE ID	DESCRIPTION	PR	AP 50:1	TR 7:1	TH 34:1	DE 40:1
32-1	BUILDING	-	-	(4.5')	-	-
32-2	POLE	12.2'	-	-	-	-
32-3	POLE	(.8')	-	-	-	-
32-4	POLE	(1.7')	-	-	-	-
32-5	POLE	(1.1')	-	-	-	-
32-6	BUILDING	3.2'	-	-	-	-
32-7	TOWER	33.0'	-	-	-	-
32-8	TRAIL	-	1.1'	-	1.1'	(3.9')

SURFACES: PR=PRIMARY AP=PT 77 APPROACH TR=TRANSITIONAL TH=THRESHOLD  
DE=DEPARTURE GQS=GLIDEPATH QUALIFICATION SURFACE #.#' = ABOVE SURFACE  
(#.#')=BELOW SURFACE \* = OBJECT LIGHTED \*\*=MAY REQUIRE OBJECT LIGHTING ~ =RPZ PENETRATION  
NOTE: AN AERONAUTICAL SURVEY IS REQUIRED FOR OBSTACLE VERIFICATION

NOTE: RED OBSTRUCTION IN PROFILE VIEW INDICATES OBSTRUCTION TO AN AIRSPACE SURFACE. FAA AERONAUTICAL STUDY REQUIRED TO DETERMINE IF OBJECT IS A HAZARD TO AIR NAVIGATION

LEGEND	
	NATURAL GROWTH OBJECT (I.E. TREE)
	MOBILE OBJECT (I.E. VEHICLE)
	FIXED OBJECT (I.E. POLE)
	AIRSPACE OBSTRUCTING OBJECT

STATION	ELEVATION	HIGH/LOW
10+00	3192.2	HIGH
30+62.8	3177.8	-
66+99	3159.8	-
96+99	3142.8	LOW

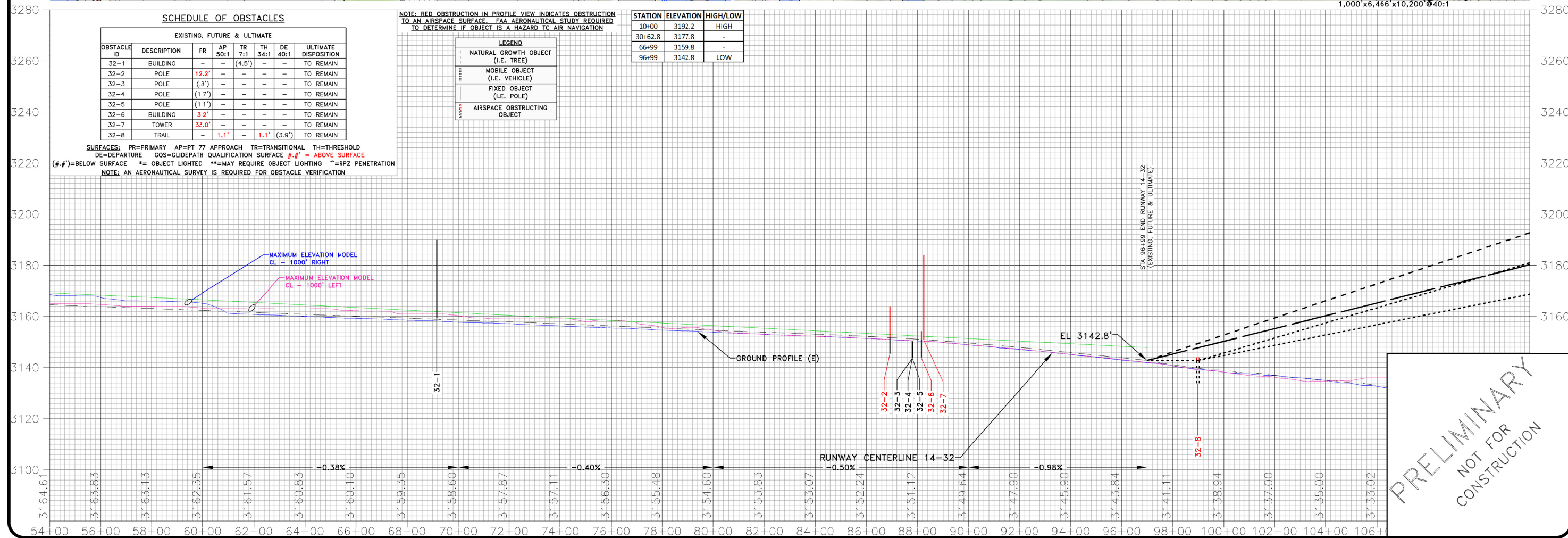

PRELIMINARY  
NOT FOR  
CONSTRUCTION

**INNER APPROACH SURFACE  
RUNWAY 14-32**

DRAFTED  
TLG  
REVIEWED  
KP  
PROJECT NUMBER  
10512113  
LAST REVISED DATE  
08/20/2015

SHEET  
**A-16**



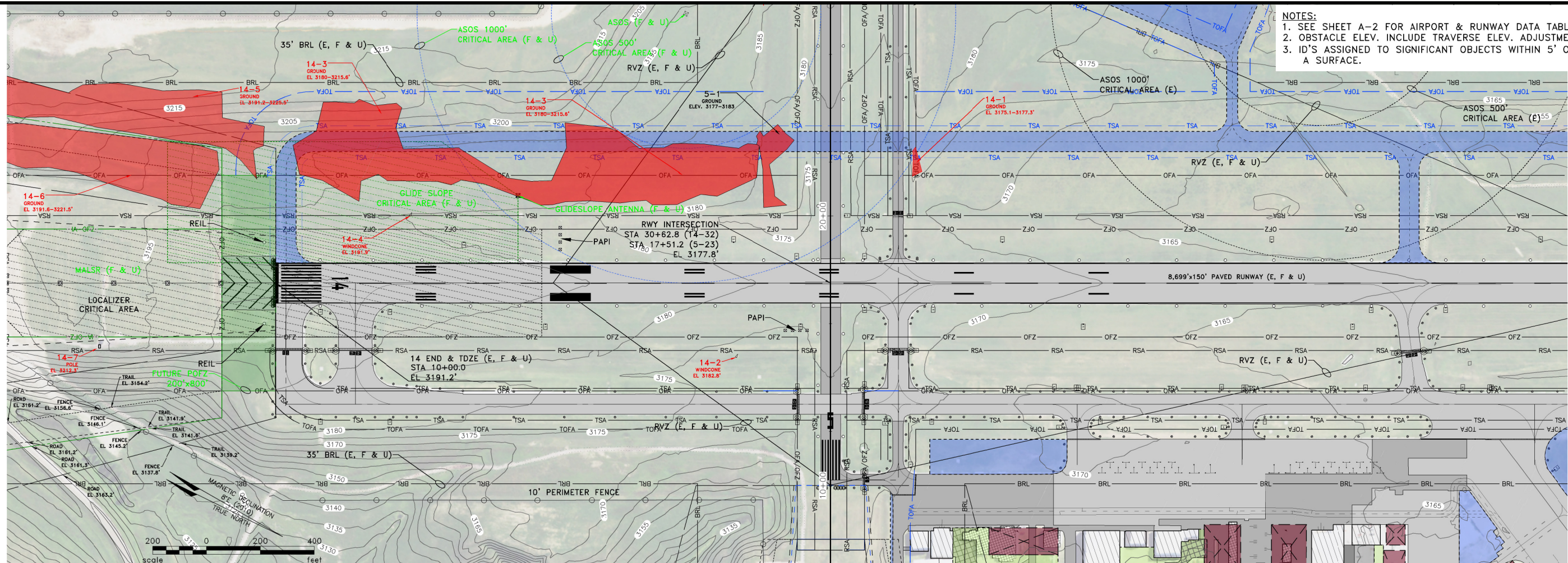

- NOTES:
1. SEE SHEET A-2 FOR AIRPORT & RUNWAY DATA TABLES.
  2. OBSTACLE ELEV. INCLUDE TRAVERSE ELEV. ADJUSTMENTS.
  3. ID'S ASSIGNED TO SIGNIFICANT OBJECTS WITHIN 5' OF A SURFACE.



**RAPID CITY REGIONAL AIRPORT**

CITY OF RAPID CITY (OWNER)  
RAPID CITY, SOUTH DAKOTA

TO BE USED AS A COMPLETE DRAWING SET FOR PLANNING PURPOSES ONLY, NOT FOR CONSTRUCTION

STATION	ELEVATION	HIGH/LOW
10+00	3192.2	HIGH
30+62.8	3177.8	-
66+99	3159.8	-
96+99	3142.8	LOW

NOTE: RED OBSTRUCTION IN PROFILE VIEW INDICATES OBSTRUCTION TO AN AIRSPACE SURFACE. FAA AERONAUTICAL STUDY REQUIRED TO DETERMINE IF OBJECT IS A HAZARD TO AIR NAVIGATION

LEGEND
NATURAL GROWTH OBJECT (I.E. TREE)
MOBILE OBJECT (I.E. VEHICLE)
FIXED OBJECT (I.E. POLE)
AIRSPACE OBSTRUCTING OBJECT

**SCHEDULE OF OBSTACLES**

OBSTACLE ID	DESCRIPTION	EXISTING (E)					FUTURE & ULTIMATE (F & U)					FUTURE DISPOSITION
		PR	AP 34:1	TR 7:1	TH 20:1	DE 40:1	PR	AP 50:1	TR 7:1	TH 34:1	DE 40:1	
14-1	GROUND	0-1.4'	-	0-1.4'	-	-	0-1.4'	-	0-1.4'	-	-	TO REMAIN
14-2	WINDCONE	2.2'	-	-	-	-	2.2'	-	-	-	-	TO REMAIN
14-3	GROUND	0-1.4'	-	0-1.3'	-	-	0-1.4'	-	0-1.3'	-	-	TO BE LOWERED
14-4	WINDCONE	3.3'	-	-	-	-	3.3'	-	-	-	-	TO REMAIN
14-5	GROUND	0-0.5'	-	(1.9)-7.5'	-	-	0-0.5'	-	0-11'	-	-	TO BE LOWERED
14-6	GROUND	-	(3.9)-1.3'	-	(12.9)-8'(7.1)-0.5'	-	0-9.9'	-	(3.9)-1.1'(7.1)-0.5'	-	-	TO BE LOWERED

SURFACES: PR=PRIMARY AP=PT 77 APPROACH TR=TRANSITIONAL TH=THRESHOLD  
DE=DEPARTURE GOS=GLIDEPATH QUALIFICATION SURFACE #.#' = ABOVE SURFACE  
(#.#')=BELOW SURFACE \* = OBJECT LIGHTED \*\*=MAY REQUIRE OBJECT LIGHTING ~ =RPZ PENETRATION  
NOTE: AN AERONAUTICAL SURVEY IS REQUIRED FOR OBSTACLE VERIFICATION

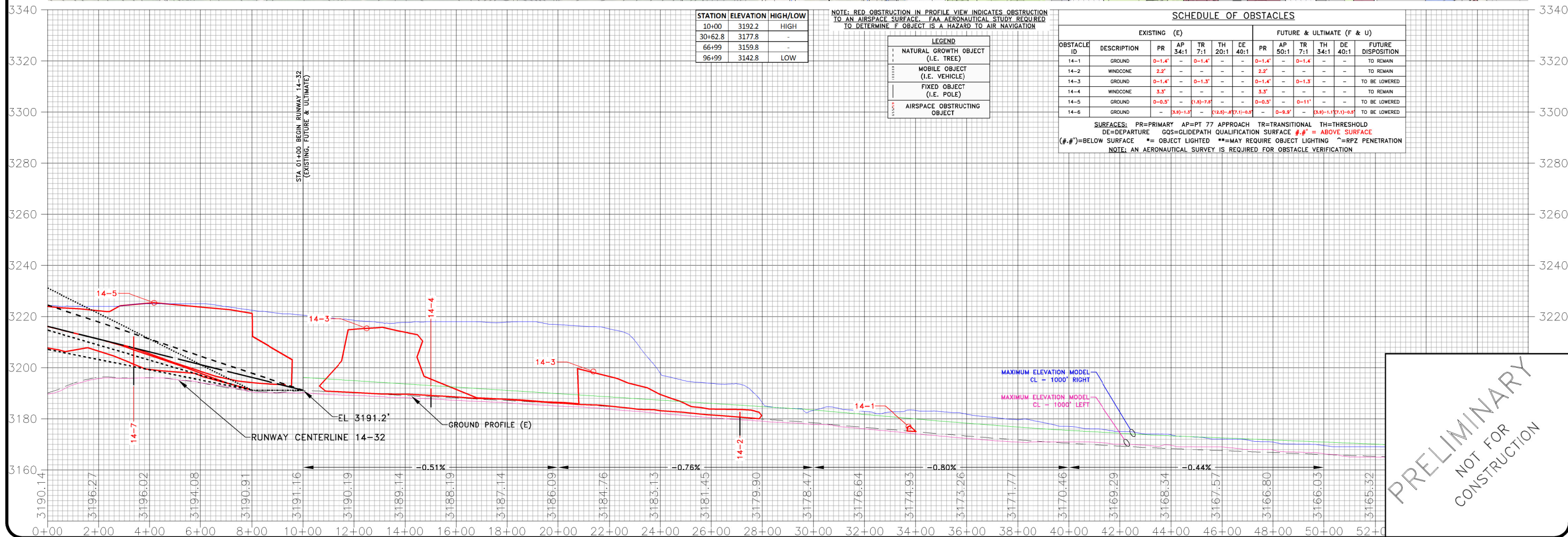

PRELIMINARY  
NOT FOR  
CONSTRUCTION

**INNER APPROACH SURFACE  
RUNWAY 14-32**

DRAFTED  
TLG  
REVIEWED  
KP  
PROJECT NUMBER  
10512113  
LAST REVISED DATE  
08/20/2015

SHEET  
**A-15**