

LEGEND		
EXISTING (E)	ITEM	ULTIMATE (ULT)
---	AIRPORT PROPERTY LINE	---
---	RPZ/AIRSPACE EASEMENT	---
---	BRL BUILDING RESTRICTION LINE (BRL)	---
---	OFA RUNWAY OBJECT FREE AREA (OFA)	---
---	RSA RUNWAY SAFETY AREA (RSA)	---
---	TOFA TAXIWAY OBJECT FREE AREA (TOFA)	---
N/A	BUILDING/BUILDING LOTS	---
---	BITUMINOUS/CONCRETE SURFACE	---
---	LANDSIDE PAVED SURFACE	---
---	AIRPLANE TIEDOWN	N/A
N/A	BUILDING/PAVEMENT TO BE REMOVED	---

BUILDING IDENTIFICATION TABLE (E)				
#	DESCRIPTION	TOP ELEV.	OBSTRUCTION LIGHTING/MARKING	DISPOSITION
19	FBO Hangar and Terminal	3190.6	None	To Remain
44	SASO Hangar	3199.0	None	To Remain
52	National Guard	3206.6	None	To Remain
54	National Guard	3189.3	None	To Remain
55	Private Hangar	3193.1	None	To Remain
62	Fire Department	3196.2	None	To Remain
70	Car Rental QTA	3182.1	None	To Remain
71	Terminal Building	3221.8	None	To Remain
72	GA Terminal Building		None	To Remain

LOT TABLE (F & U)	
#	DESCRIPTION
P	76' x 70' HANGAR LOT
Q	192' x 80' HANGAR LOT
T	250' x 80' CARGO LOT
U	45' x 45' CONTROL TOWER LOT
V	425' x 170' & 230' x 190' SDARNG LOT

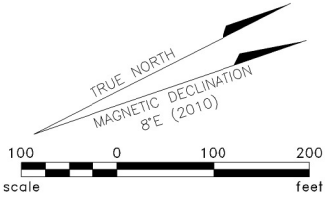

PRELIMINARY
NOT FOR
CONSTRUCTION

RAPID CITY REGIONAL AIRPORT

CITY OF RAPID CITY (OWNER)
RAPID CITY, SOUTH DAKOTA

TO BE USED AS A COMPLETE DRAWING SET FOR PLANNING PURPOSES ONLY, NOT FOR CONSTRUCTION

TERMINAL AREA
(EXISTING & ULTIMATE)

DRAFTED
MTK
REVIEWED
KP
PROJECT NUMBER
10512113
LAST REVISED DATE
08/20/2015
SHEET
A-7

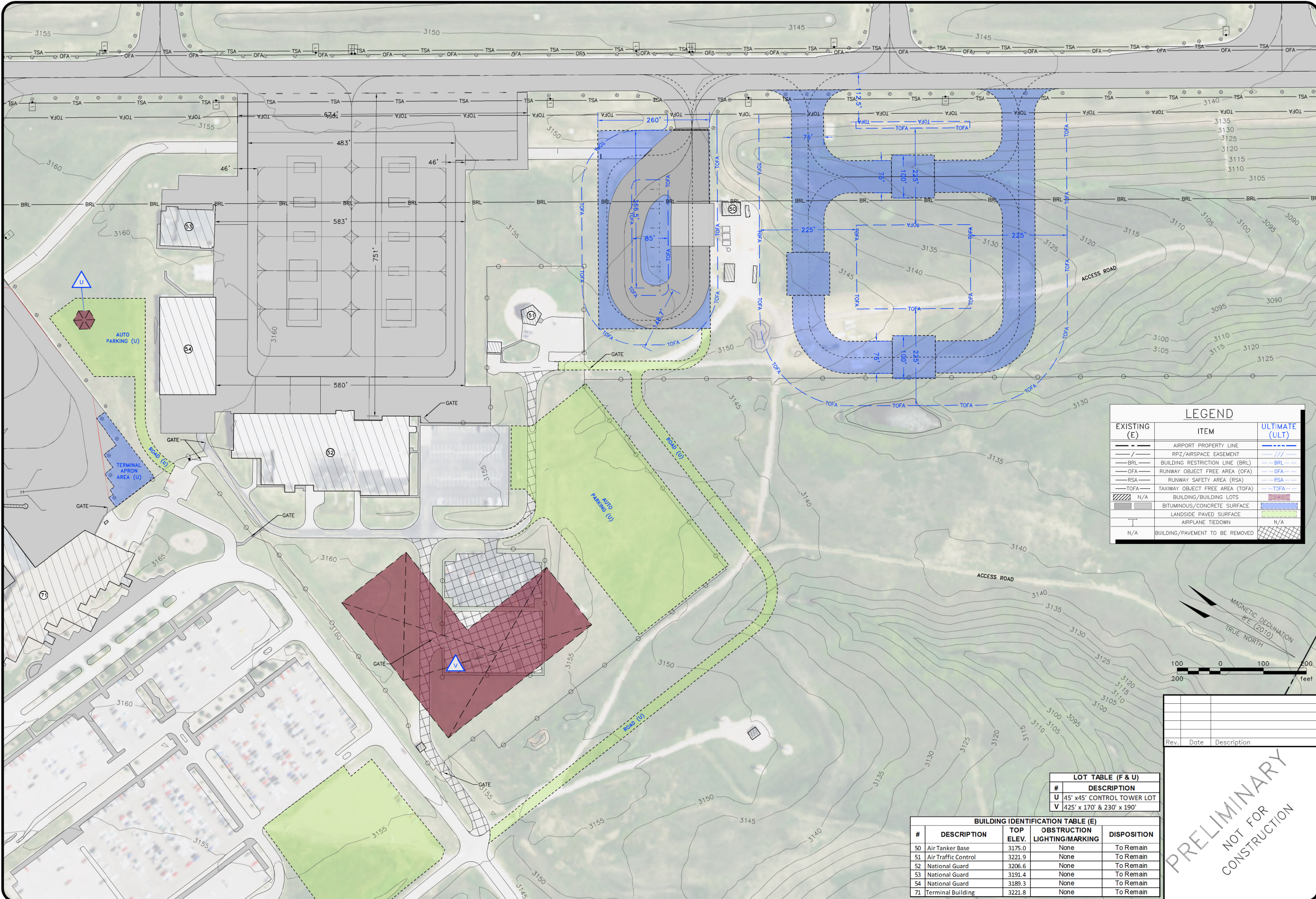

RAPID CITY REGIONAL AIRPORT
CITY OF RAPID CITY (OWNER)
RAPID CITY, SOUTH DAKOTA

TO BE USED AS A COMPLETE DRAWING SET FOR PLANNING PURPOSES ONLY, NOT FOR CONSTRUCTION

**FOREST SERVICE AREA
(EXISTING & ULTIMATE)**

DRAFTED
MTK
REVIEWED
KP
PROJECT NUMBER
10512113
LAST REVISED DATE
08/20/2015
SHEET
A-8

LEGEND		
EXISTING (E)	ITEM	ULTIMATE (ULT)
---	AIRPORT PROPERTY LINE	---
---	RPZ/AIRSPACE EASEMENT	---
---	BUILDING RESTRICTION LINE (BRL)	---
---	RUNWAY OBJECT FREE AREA (OFA)	---
---	RUNWAY SAFETY AREA (RSA)	---
---	TAXIWAY OBJECT FREE AREA (TOFA)	---
---	N/A	---
---	BUILDING/BUILDING LOTS	---
---	BITUMINOUS/CONCRETE SURFACE	---
---	LANDSIDE PAVED SURFACE	---
---	AIRPLANE TIEDOWN	---
---	N/A	---
---	BUILDING/PAVEMENT TO BE REMOVED	---



Rev.	Date	Description

LOT TABLE (F & U)	
#	DESCRIPTION
U	45' x 45' CONTROL TOWER LOT
V	425' x 170' & 230' x 190'

BUILDING IDENTIFICATION TABLE (E)				
#	DESCRIPTION	TOP ELEV.	OBSTRUCTION LIGHTING/MARKING	DISPOSITION
50	Air Tanker Base	3175.0	None	To Remain
51	Air Traffic Control	3221.9	None	To Remain
52	National Guard	3206.6	None	To Remain
53	National Guard	3191.4	None	To Remain
54	National Guard	3189.3	None	To Remain
71	Terminal Building	3221.8	None	To Remain

PRELIMINARY
NOT FOR
CONSTRUCTION



IIY REGIONAL AIRPORT
CITY OF RAPID CITY (OWNER)
RAPID CITY, SOUTH DAKOTA

NOT TO BE USED AS A COMPLETE DRAWING SET FOR PLANNING PURPOSES ONLY. NOT FOR CONSTRUCTION

EAST GENERAL AVIATION APRON
(ULTIMATE)

DRAFTED
MTK
REVIEWED
KP
PROJECT NUMBER
10512113
LAST REVISED DATE
08/20/2015

SHEET
A-9

© KLJ 2015



Sep 16, 2015 - 5:35pm - J:\airport\10512113\CAD\ALP\10512113_Terminal.dwg (GA-East(U))

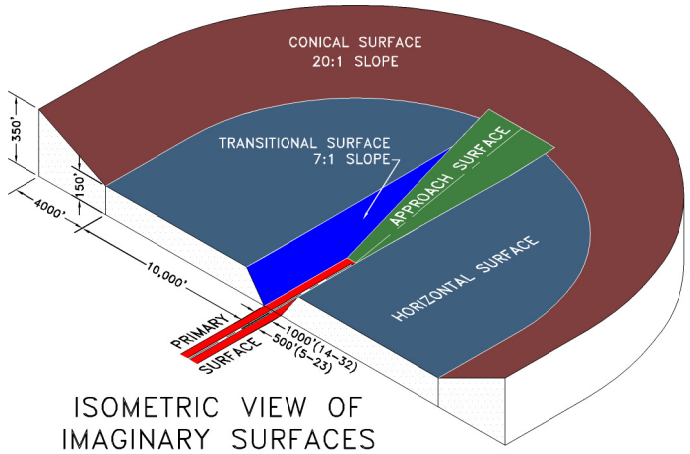
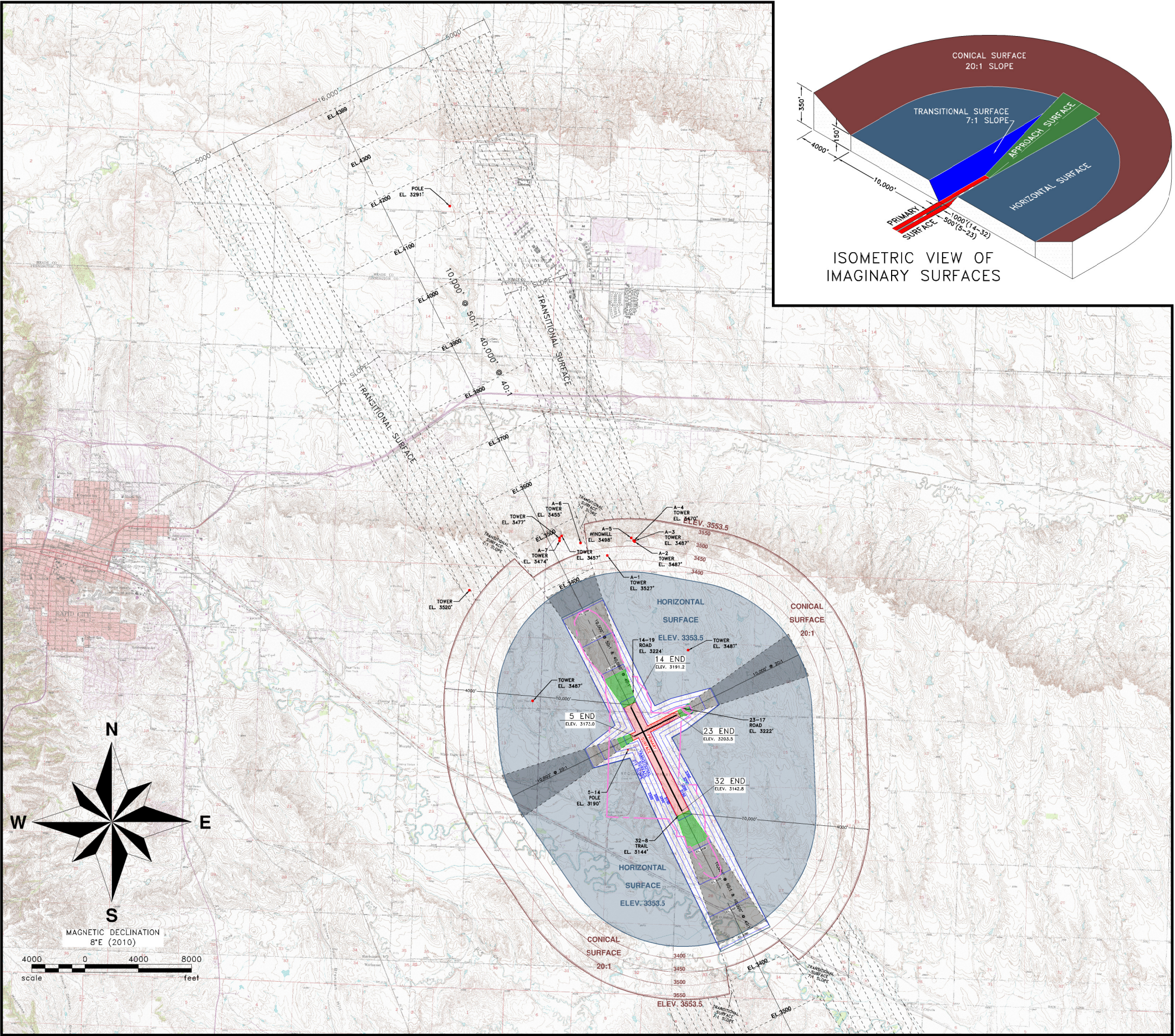

PRIMARY SURFACE AREA
- NO OBJECTS ALLOWED
IN PRIMARY SURFACE

TRANSITIONAL SURFACE AREA
- T1 ELEVATION 3150 MSL
- T2 ELEVATION 3200 MSL
- T3 ELEVATION 3250 MSL
- T4 ELEVATION 3300 MSL

HORIZONTAL SURFACE AREA
- H1 ELEVATION 3353.5 MSL

CONICAL SURFACE AREA
- C1 ELEVATION 3400 MSL
- C2 ELEVATION 3450 MSL
- C3 ELEVATION 3500 MSL
- C4 ELEVATION 3550 MSL
- C5 ELEVATION 3553.5 MSL

PART 77 AIRSPACE SCHEDULE OF OBSTACLES
RAPID CITY REGIONAL AIRPORT

OBSTACLE		CHARACTERISTICS			
ID	DESCRIPTION	ELEVATION AMSL (FT.)	PART 77 SURFACE	OBJECT PENETRATION	FUTURE DISPOSITION
14-19	ROAD	3224	APPROACH	E.F&U=2.9'(A)	TO BE RELOCATED
32-8	TRAIL	3144	APPROACH	E.F&U=1.1'(A)	TO REMAIN
5-14	POLE	3190	TRANSITIONAL	E.F&U=67.4'(B)	TO REMAIN
23-17	ROAD	3222	TRANSITIONAL	E.F&U=60.4'(B)	TO REMAIN
A-1	TOWER	3527	CONICAL	E.F&U=107'(A)	TO REMAIN
A-2	TOWER	3487	CONICAL	E.F&U=21'(A)	TO REMAIN
A-3	TOWER	3487	CONICAL	E.F&U=21'(A)	TO REMAIN
A-4	TOWER	3487	CONICAL	E.F&U=21'(A)	TO REMAIN
A-5	WINDMILL	3498	CONICAL	E.F&U=30'(A)	TO REMAIN
A-6	TOWER	3455	APPROACH	E.F&U=5'(B)	TO REMAIN
A-7	TOWER	3474	APPROACH	E.F&U=1.5'(B)	TO REMAIN
A-8	TOWER	3477	APPROACH	E.F&U=3'(B)	TO REMAIN

(A) = ABOVE SURFACE
(B) = BELOW SURFACE
** LIGHTING OF OBJECT REQUIRED
(OL) = OBJECT LIGHTED
(U) = UNVERIFIED LIGHTING

- NOTES:
1. SEE SHEET A-2 FOR AIRPORT & RUNWAY DATA TABLES.
 2. FOR CLOSE-IN RUNWAY AIRSPACE OBSTACLES, SEE INNER APPROACH SURFACE SHEETS.
 3. AIRSPACE APPLIED TO THIS DRAWING IS BASED ON PART 77 OF THE F.A.R.'s.
 4. OBSTACLE EL. INCLUDE TRAVERSE EL. ADJUSTMENTS.
 5. ID'S ASSIGNED TO SIGNIFICANT OBJECTS WITHIN 5' OF A SURFACE.

Rev.

Date

Description

PRELIMINARY
NOT FOR
CONSTRUCTION



TO BE USED AS A COMPLETE DRAWING SET FOR PLANNING PURPOSES ONLY, NOT FOR CONSTRUCTION

PART 77 AIRSPACE
(ULTIMATE)

DRAFT
APT
REVIEWED
KP
PROJECT NUMBER
10512113
LAST REVISED DATE
08/20/2015

SHEET
A-10

